



**Palm Lea, Brandon, DH7 8SW**  
**3 Bed - House - End Terrace**  
**Offers Over £65,000**

**ROBINSONS**  
SALES • LETTINGS • AUCTIONS • SURVEYS

Going to Best and Final Offers by 12noon Friday 14th April \*\*  
Pleasant Position \*\* Modern Kitchen & Bathroom \*\* Front  
Outlook \*\* Garden \*\* Popular Location \*\* Ideal Family Home,  
First Buy or Buy to Let (approx. 10% Yield) \*\*

Briefly comprises: entrance, lounge, dining room, kitchen and  
utility room. The first floor has three bedrooms and  
bathroom/wc. Outside is a front and side garden with the front  
having a pleasant outlook.

Palm Lea is situated in the popular village of Brandon within  
walking distance of a selection of local amenities, a more  
comprehensive range of professional, recreational and retail  
services are available in nearby Durham City. The area benefits  
from excellent transportation links enabling prospective  
purchasers to commute with ease to any of the Regional  
centres.

EPC Rating D  
Council tax band A - approx. £1469pa  
Tenure - Freehold

#### **ENTRANCE HALL**

#### **LOUNGE**

18'5" x 9'9" (5.61 x 2.97)

#### **DINING ROOM**

10'11" x 7'4" (3.33 x 2.24)

#### **KITCHEN**

9'1" x 8'0" (2.77 x 2.44)

#### **UTILITY AREA**

5'11" x 4'10" (1.80 x 1.47)

#### **FIRST FLOOR: LANDING**

#### **BEDROOM 1**

11'0" x 10'2" (3.35 x 3.10)

#### **BEDROOM 2**

9'10" x 9'1" (3.00 x 2.77)

#### **BEDROOM 3**

8'0" x 8'0" (2.44 x 2.44)

#### **BATHROOM**

#### **EXTERNALLY**

Outside is a front and side garden with the front having a  
pleasant outlook.







# OUR SERVICES

Mortgage Advice

Conveyancing

Surveys and EPCs

Property Auctions

Lettings and Management

Strategic Marketing Plan

Dedicated Property Manager

## Palm Lea

Approximate Gross Internal Area  
1076 sq ft - 100 sq m

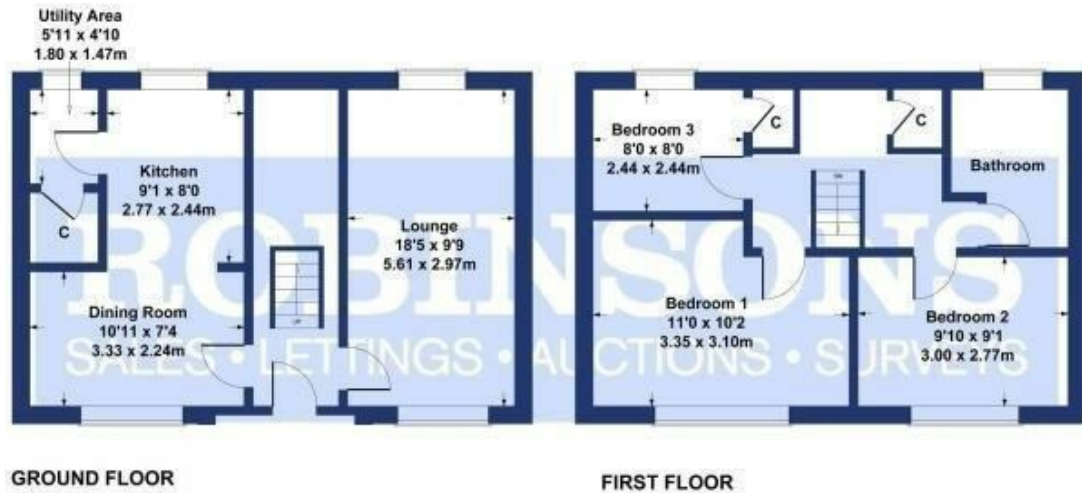

### SKETCH PLAN FOR ILLUSTRATIVE PURPOSES ONLY

All measurements walls, doors, windows, fittings and appliances, their sizes and locations, are approximate only. They cannot be regarded as being a representation by the seller, nor their agent.

Produced by Potterplans Ltd. 2018

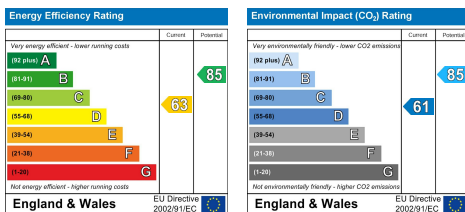

### DURHAM

1-3 Old Elvet  
DH1 3HL

T: 0191 386 2777 (Sales)

T: 0191 383 9994 (option1) (Lettings)

E: [info@robinsonsdurham.co.uk](mailto:info@robinsonsdurham.co.uk)

### DURHAM REGIONAL HEAD OFFICE

19A old Elvet  
DH1 3HL

T: 0191 383 0777

E: [info@robinsonsdurham.co.uk](mailto:info@robinsonsdurham.co.uk)

### CHESTER-LE-STREET

45 Front Street  
DH3 3BH

T: 0191 387 3000

E: [info@robinsonscsls.co.uk](mailto:info@robinsonscsls.co.uk)

### BISHOP AUCKLAND

120 Newgate Street  
DL14 7EH

T: 01388 458111

E: [info@robinsonsbishop.co.uk](mailto:info@robinsonsbishop.co.uk)

### CROOK

Royal Corner  
DL15 9UA

T: 01388 763477

E: [info@robinsonscrook.co.uk](mailto:info@robinsonscrook.co.uk)

### SPENNYMOOR

11 Cheapside  
DH16 6QE

T: 01388 420444

E: [info@robinsonsspennymoor.co.uk](mailto:info@robinsonsspennymoor.co.uk)

### SEDGEFIELD

3 High Street  
TS21 2AU

T: 01740 621777

E: [info@robinsonssedgefield.co.uk](mailto:info@robinsonssedgefield.co.uk)

Every care has been taken with the preparation of these particulars, but they are for general guidance only and complete accuracy cannot be guaranteed. If there is any point, which is of particular importance please ask or professional verification should be sought. All dimensions are approximate. The mention of fixtures, fittings &/or appliances does not imply they are in full efficient working order. Photographs are provided for general information and it cannot be inferred that any item shown is included in the sale. These particulars do not constitute a contract or part of a contract.

Robinsons can recommend financial services, surveying and conveyancing services to sellers and buyers. Robinsons staff may benefit from referral incentives relating to these services.



# ROBINSONS

SALES • LETTINGS • AUCTIONS • SURVEYS

1 Old Elvet, Durham City, Durham, DH1 3HL | Tel: 0191 386 2777 | [info@robinsonsdurham.co.uk](mailto:info@robinsonsdurham.co.uk)

[www.robinsonsestateagents.co.uk](http://www.robinsonsestateagents.co.uk)